

**TWO-TRAY PAPER FEED UNIT**  
**(Machine Code: G568)**

---

# 1. REPLACEMENT AND ADJUSTMENT

## 1.1 COVER REPLACEMENT

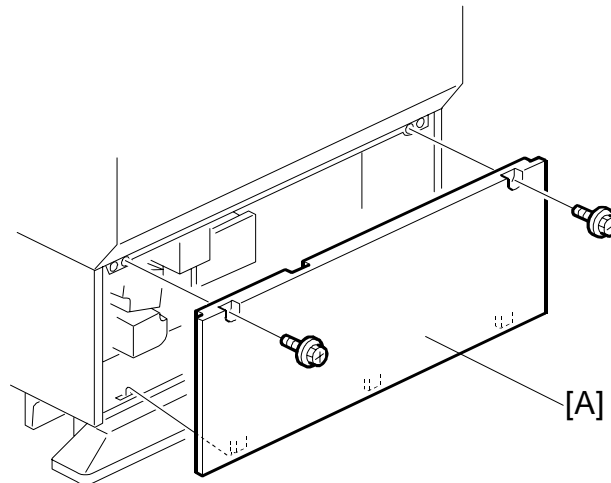

G568R102.WMF

1. Rear cover [A] (🔩 x 2)

## 1.2 ROLLER REPLACEMENT

### 1.2.1 PAPER FEED, SEPARATION, AND PICK-UP ROLLERS

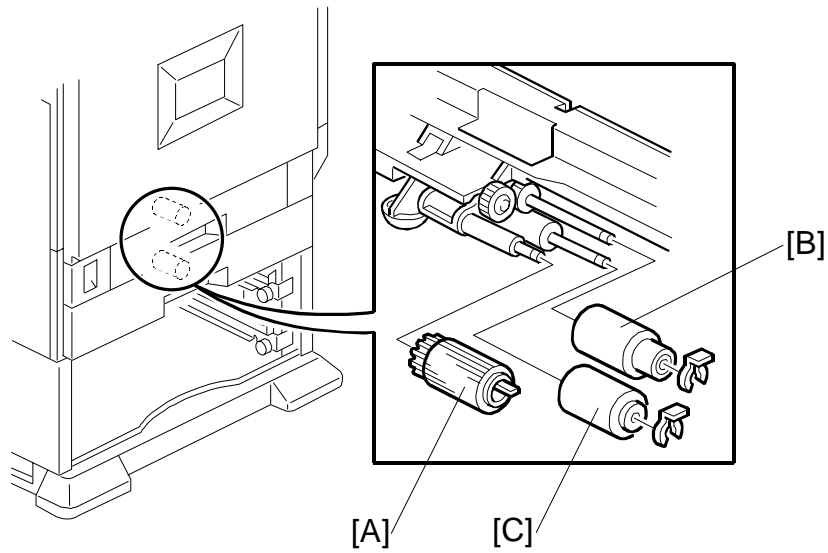

G568R101.WMF

1. Paper tray
2. Pick-up roller [A] (1 hook)
3. Paper Feed Roller [B] (☞ x 1)
4. Separation Roller [C] (☞ x 1)

## 1.3 PAPER FEED MOTOR AND MAIN BOARD

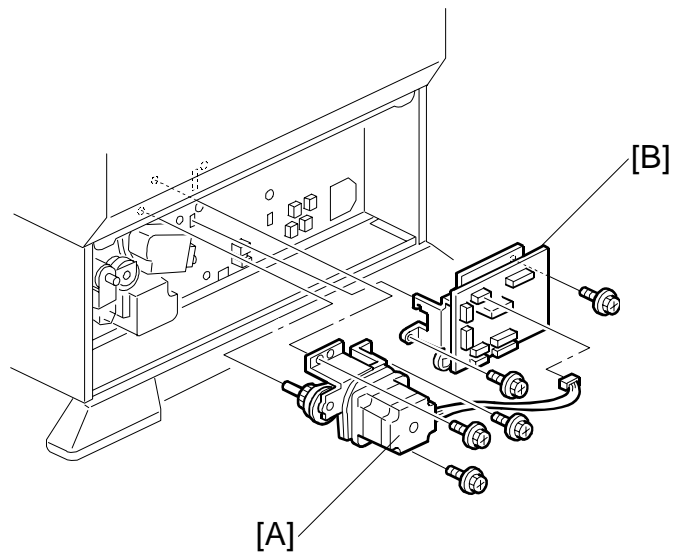

G568R103.WMF

1. Rear cover (☛ 1.1 COVER REPLACEMENT)
2. Paper feed motor [A] (☛ x 1, 🔩 x 3)
3. Main board [B] (☛ x 2)

## 1.4 TRAY LIFT MOTORS

1. Rear cover (☛ 1.1 COVER REPLACEMENT)
2. Tray lift motor [A] (☛ x 1, ⚙ x 2)

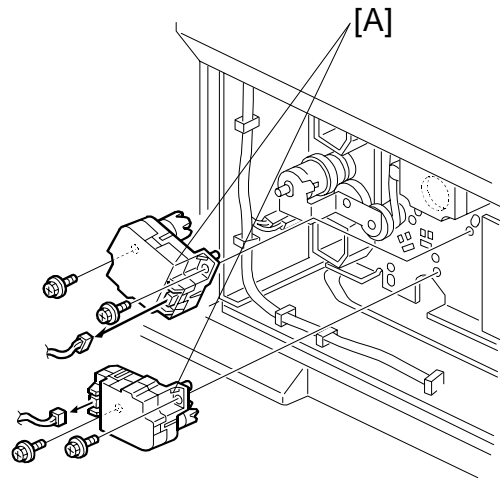

G568R104.WMF

## 1.5 PAPER FEED CLUTCHES

1. Rear cover (☛ 1.1 COVER REPLACEMENT)
2. Paper feed clutches [A] (⚙ x 1, 1 bracket, 1 bushing)

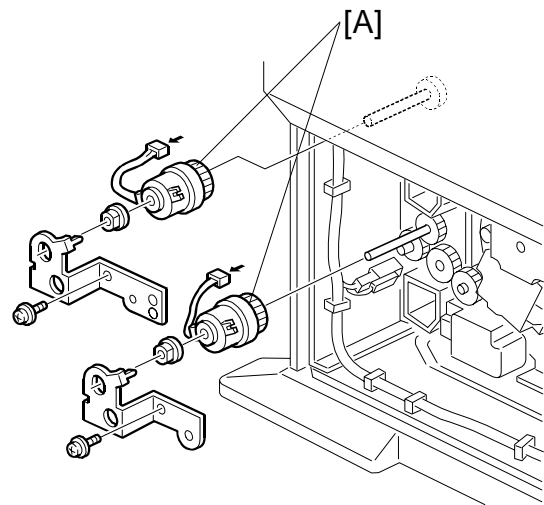

G568R105.WMF

## 1.6 PAPER FEED UNIT REPLACEMENT

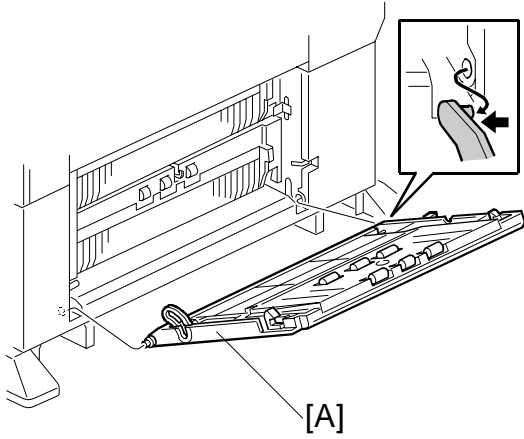

G568R107.WMF

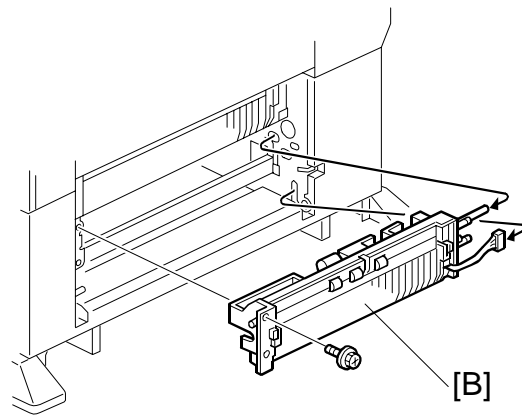

G568R108.WMF

1. Vertical transport cover [A] (1 hook)
2. Paper feed unit [B] (⚙ x 2, 📄 x 1)

## 2. DETAILED DESCRIPTIONS

### 2.1 OVERVIEW

#### 2.1.1 MECHANICAL COMPONENT LAYOUT

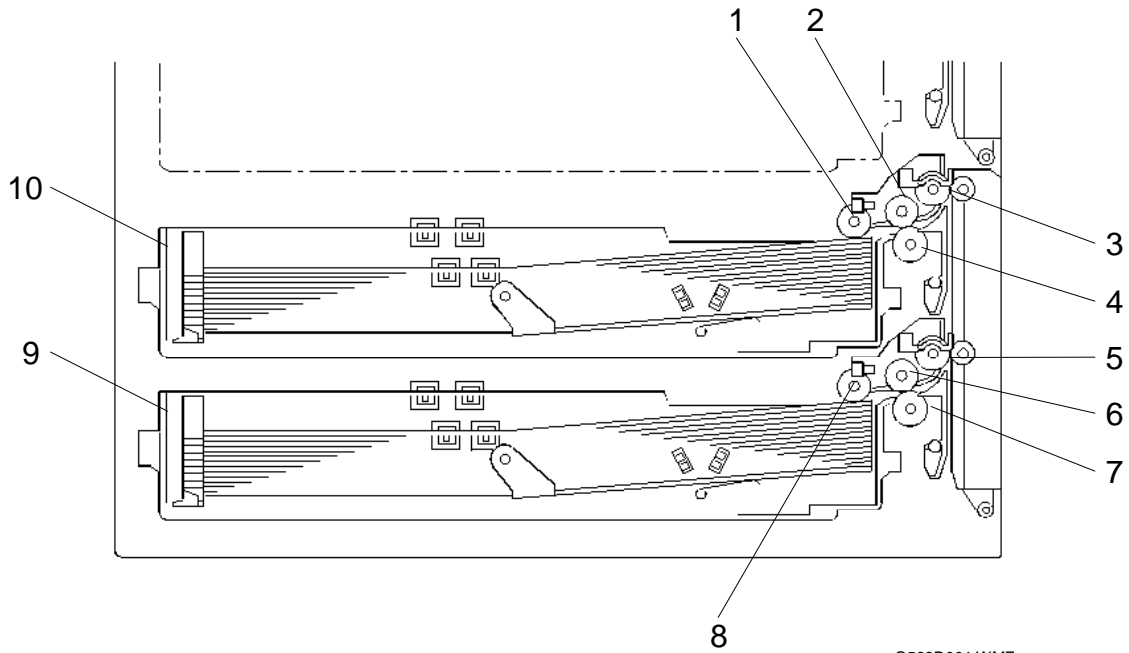

G568D001.WMF

- |                            |                            |
|----------------------------|----------------------------|
| 1. Upper Pick-up Roller    | 6. Lower Paper Feed Roller |
| 2. Upper Paper Feed Roller | 7. Lower Separation Roller |
| 3. Upper Relay Roller      | 8. Lower Pick-up Roller    |
| 4. Upper Separation Roller | 9. Lower Tray              |
| 5. Lower Relay Roller      | 10. Upper Tray             |

### 2.1.2 ELECTRICAL COMPONENT LAYOUT

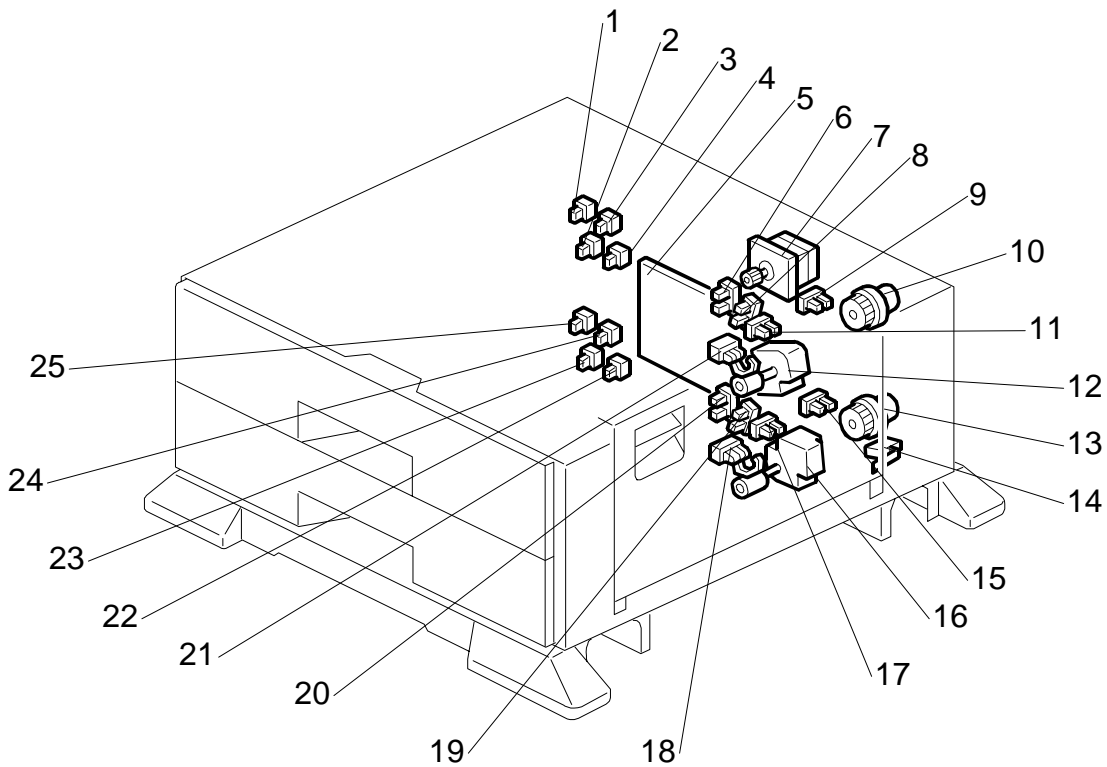

G568D101.WMF

- |                                |                                 |
|--------------------------------|---------------------------------|
| 1. Paper Size Switch 1         | 14. Vertical Guide Switch       |
| 2. Paper Size Switch 2         | 15. Lower Lift Sensor           |
| 3. Paper Size Switch 3         | 16. Lower Tray Lift Motor       |
| 4. Paper Size Switch 4         | 17. Lower Paper End Sensor      |
| 5. Main Board                  | 18. Lower Relay Sensor          |
| 6. Upper Paper Height 1 Sensor | 19. Lower Paper Height 2 Sensor |
| 7. Paper Feed Motor            | 20. Lower Paper Height 1 Sensor |
| 8. Upper Paper Height 2 Sensor | 21. Upper Relay Sensor          |
| 9. Upper Lift Sensor           | 22. Paper Size Switch 4         |
| 10. Upper Paper Feed Clutch    | 23. Paper Size Switch 2         |
| 11. Upper Paper End Sensor     | 24. Paper Size Switch 3         |
| 12. Upper Tray Lift Motor      | 25. Paper Size Switch 1         |
| 13. Lower Paper Feed Clutch    |                                 |

Peripherals



### 2.1.3 DRIVE LAYOUT

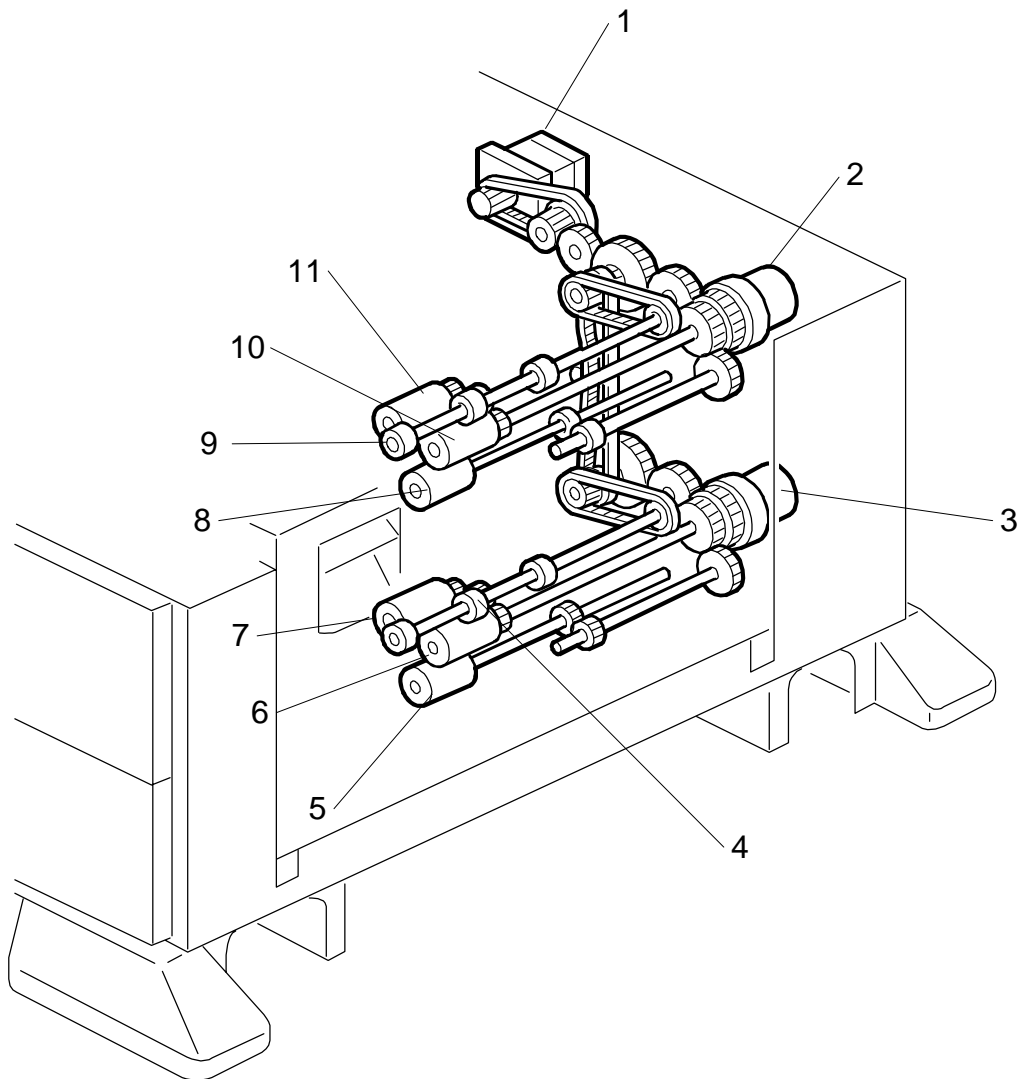

G568D102.WMF

- |                            |                             |
|----------------------------|-----------------------------|
| 1. Tray Motor              | 7. Lower Pick-up Roller     |
| 2. Upper Paper Feed Clutch | 8. Upper Separation Roller  |
| 3. Lower Paper Feed Clutch | 9. Upper Relay Roller       |
| 4. Lower Relay Roller      | 10. Upper Paper Feed Roller |
| 5. Lower Separation Roller | 11. Upper Pick-up Roller    |
| 6. Lower Paper Feed Roller |                             |

# POINT TO POINT WIRING DIAGRAM (Two-tray Paper Feed Unit: G568)

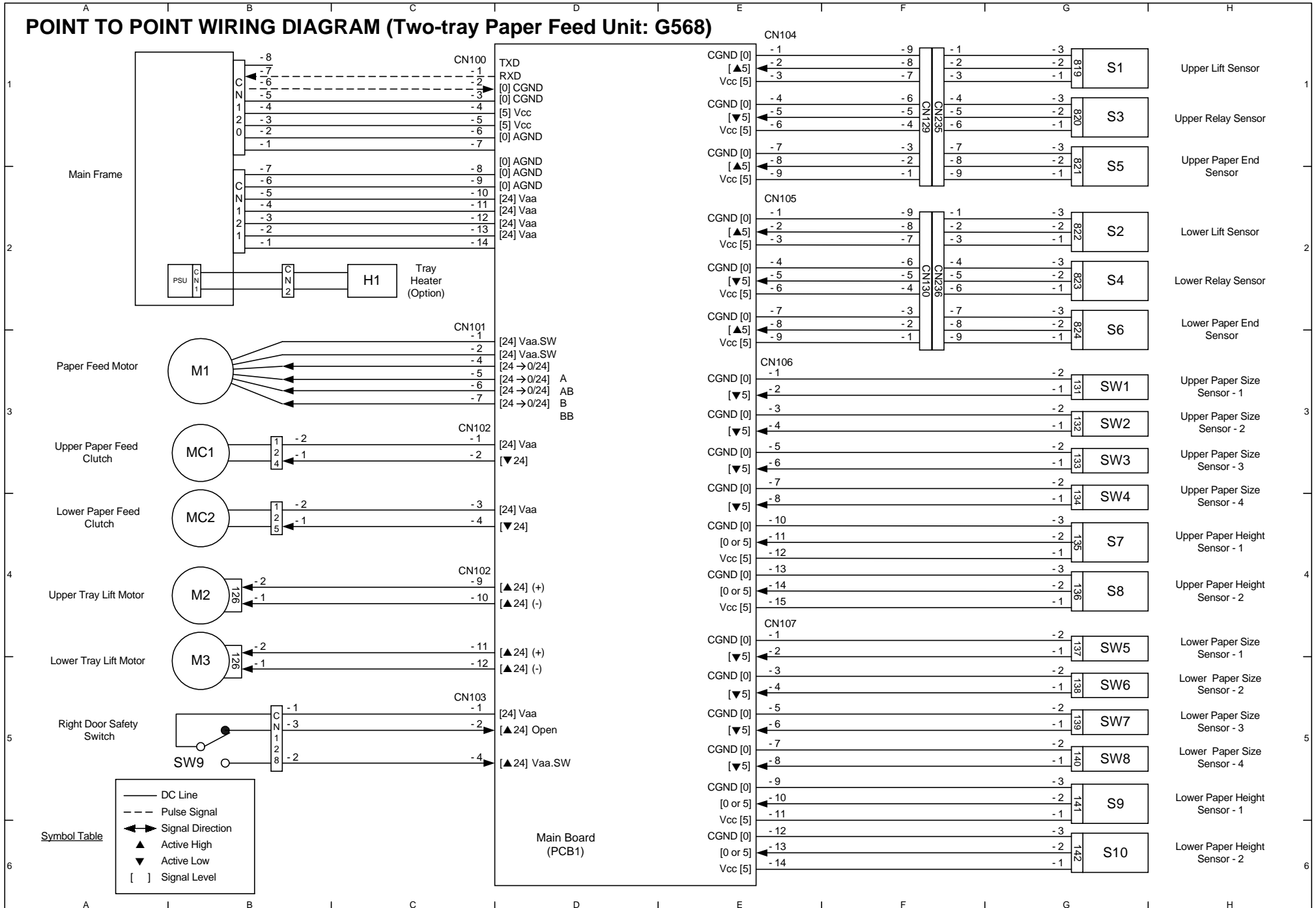

# ELECTRICAL COMPONENT LAYOUT (G568)

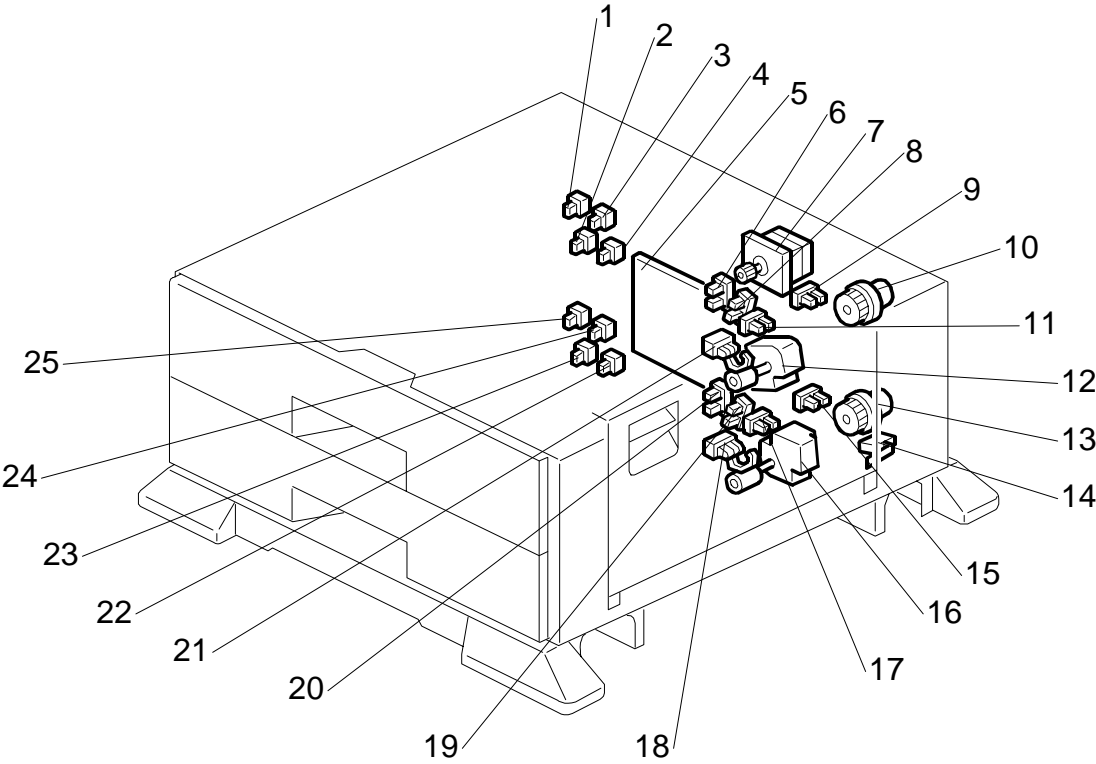

## ELECTRICAL COMPONENT DESCRIPTION (G568)

Symbol	Description	Index No.	P-to-P
<b>Motors</b>			
M1	Paper Feed	7	B3
M2	Upper Tray Lift	12	B4
M3	Lower Tray Lift	16	B5
<b>Sensors</b>			
S1	Upper Lift	9	G1
S2	Lower Lift	15	G2
S3	Upper Relay	21	G1
S4	Lower Relay	18	G2
S5	Upper Paper End	11	G1
S6	Lower Paper End	17	G2
S7	Upper Paper Height 1	6	G4
S8	Upper Paper Height 2	8	G4
S9	Lower Paper Height 1	20	G5
S10	Lower Paper Height 2	19	G6
<b>Switches</b>			
SW1	Upper Paper Size 1	1	G3
SW2	Upper Paper Size 2	2	G3
SW3	Upper Paper Size 3	3	G3
SW4	Upper Paper Size 4	4	G4
SW5	Lower Paper Size 1	25	G4
SW6	Lower Paper Size 2	23	G5
SW7	Lower Paper Size 3	24	G5
SW8	Lower Paper Size 4	22	G5
SW9	Vertical Guide	14	B5
<b>Motors</b>			
MC1	Upper Paper Feed	10	B3
MC2	Lower Paper Feed	13	B4
<b>PCBs</b>			
PCB1	Main	5	D6
<b>Heaters</b>			
H1	Tray Heater (Option)	-	C2